

### ▼ AC220V Power Solution:

Surge level: 8/20μs CM/DM 20KA

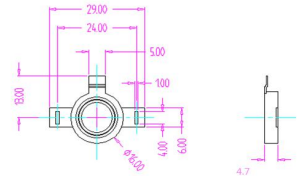
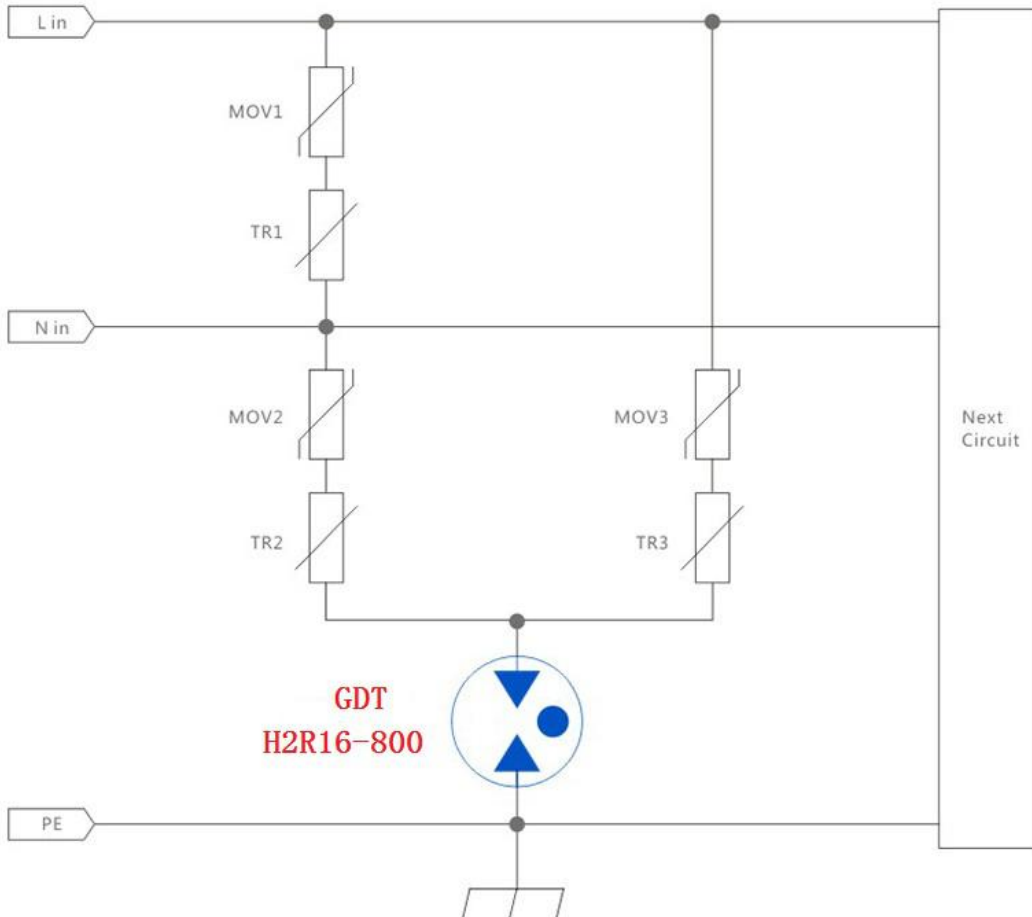

### Specification.....

| Part Number      | DC Spark-over Voltage@ 100V/S | Insulation Resistance | Impulse discharge current(8/20μs) | AC discharge current (50Hz,1s,10times) | Capacitance (1MHz) | Size    | UL Safety Certification |
|------------------|-------------------------------|-----------------------|-----------------------------------|--|--------------------|---------|-------------------------|
| GDT              | V                             | GΩ                    | 10 Times                          | A                                      | PF                 | mm      |                         |
| <b>H2R16-800</b> | 800V± 20%                     | >1                    | 20KA                              | 20                                     | ≤5                 | Φ16*4.7 | √                       |

We have laboratories of EMC,aiming to provide total turnkey service of surge/ESD test and circuit PCB improvement.

[sales@huaandz.com](mailto:sales@huaandz.com)