

**Gas Discharge Tubes**

**H2R20-600xx**

**1: Applications**

- AC Power line N-PE applications
- Class I and Class II Surge protection



**2: Dimension in mm**

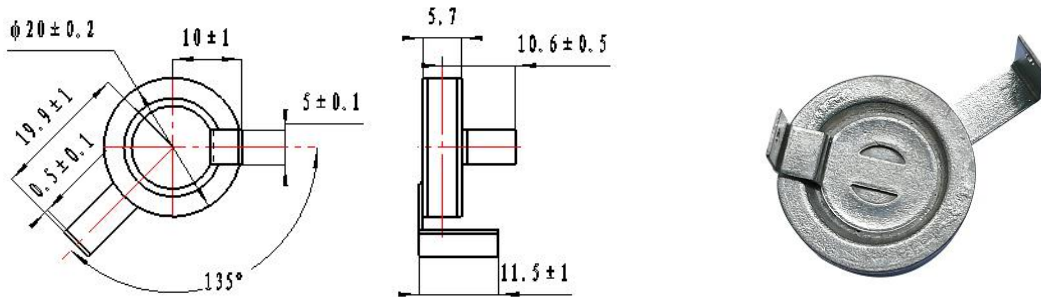

## Specification of H2R20-600xx

Dc spark-over voltage (100V/s)      1)	600V ± 20%
Maximum impulse spark-over voltage @ 5KV/μs(1.2/50us,6kv)	1000V
Breakdown time - typical values	<100ns <20ns
Insulation resistance @DC250V	1000MΩ
<b>Class I according to IEC 61643-11</b>	
Max continuous operating voltage at 50/60 Hz      Uc	260V
Nominal discharge current 8/20μs      In	40KA
Impulse current 10/350μs      Iimp	12.5KA
Follow Current at 50/60Hz at 260V      If	100A
<b>Class II according to IEC 61643-11</b>	
Max continuous operating voltage at 50/60 Hz      Uc	260V
Nominal discharge current 8/20μs      In	40KA
Maximum discharge current 8/20μs      I <sub>max</sub>	80KA
Follow Current at 50/60Hz at 260V      If	100A
AC discharge current (TOV at 1200V ,1 operation 50Hz,0.2 s)	<300A
capacitance at 1MHz	<5pF
Weight	~ 8g
UL 1449 Certification On the UL List	
Delivery time	20days
Operation and storage temperature	-40°C ... +90°C
Marking, Blue 1) At delivery AQL 0.65 level II Military Standard 105E. 2) In ionized mode Test according to ITU-T Rec. K.12.	2R600 YY      600 - Nominal voltage YY - Year of production

### 3:Application Figure



#### What can we do for our GDT?

- 1: We Can customize voltage: 230V,500V,800V...etc
- 2: We Can developed low impulse GDT
- 3: We Can customize  $U_c, I_n, I_{max}, I_{lim}, I_f, TOV$ .
- 4: We Can developed cut off follow current 100A within 1 cycle when passing zero under AC260V(50Hz)
- 5: We Can customize multi-gap GDT used in DC or AC(L-N) over voltage protection
- 6: We Can customize GDT shape, marking, special Lead wire
- 7: We Can surpass our GDT competitors, help you pass the GDT test project & improve the GDT you currently use.
- 8: We can provide fast GDT delivery, Solve your GDT delivery time problem
- 9: We can help you analyze the competitor's parameters and tell you our perfect replacement GDT part number.